

Thank you very much for purchasing optional part for LUXON AGILE.
It's necessary to decompose LUXON AGILE in the case of the use with this product. Please work on replacing after reading this manual carefully.

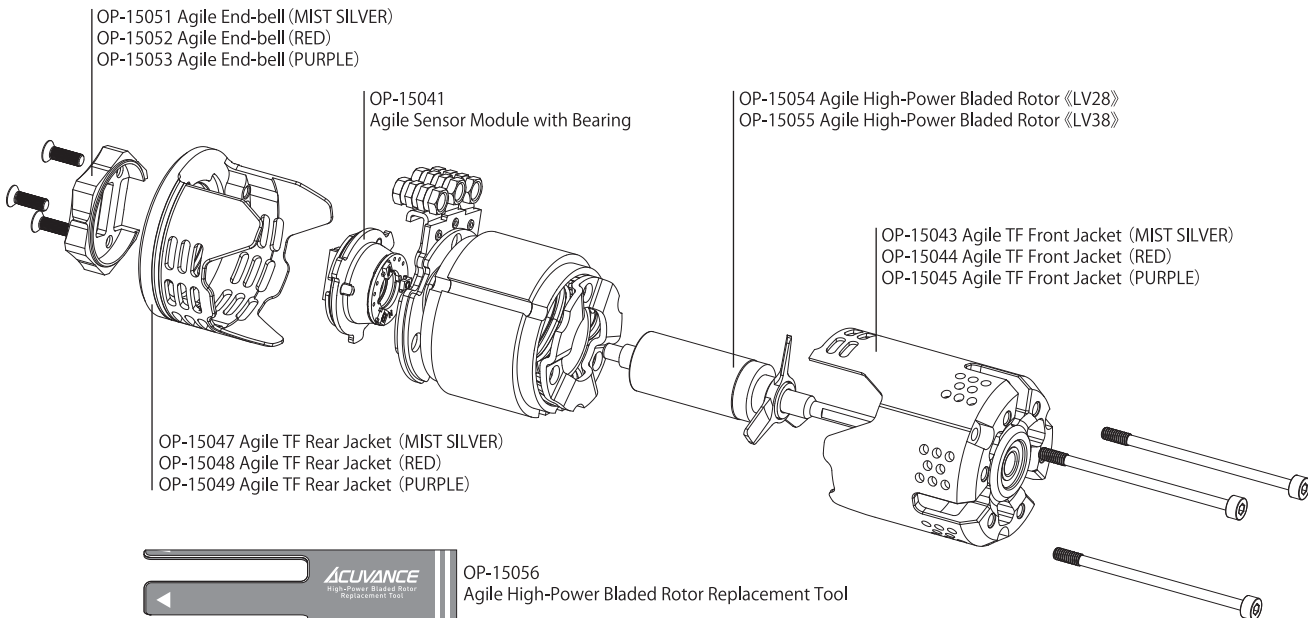

Procedure of decompose **When assemble part, do a reverse process.**

1 Take off 3 front screws

3-2 Fit a blade rotor replacement tool in the rotor first, and then insert it in the motor main body.

Perform the replacement of the rotor in this procedure.

2 Take off the front Jacket.

Front jacket

Perform the replacement of the front jacket in this procedure.

4 Take off the end-bell.

Adjusting screws for advanced angle

End-bell

Perform the replacement of the end-bell in this procedure.

3-1 Pull out the rotor.

Rotor

Perform the replacement of the rotor in this procedure.

5 Take off the sensor module.

Rear jacket

Sensor module

Perform the replacement of rear jacket and sensor module in this procedure.